

1155 Series

2.00 mm PIN Header
Single Row, Straight

Ordering Information

1155 - X X XX - XX S

Contact Plating

0 - G/F / Tin
 A - Gold Flash
 B - 10 μ " Gold
 C - 15 μ " Gold
 D - 20 μ " Gold

Insulator Type

0 - 2.0mm
 2 - 1.5mm
 3 - 2.00+1.50mm
 6 - dual body
 7 - 2.00+2.00+2.00mm

S - Straight

NO. of Contact
 2 TO 40 Positions

PIN Type
 Please refer to Drawing

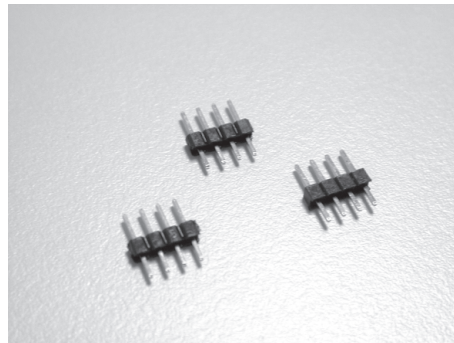

Dimensions

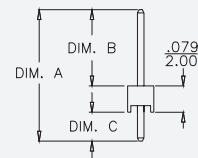
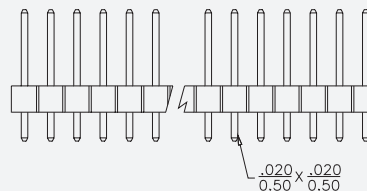
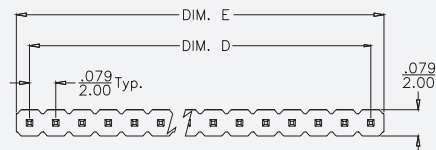

$$\text{DIM D} = \frac{.079"}{2.00\text{mm}} \times \text{<NO OF SPACE>}$$

$$\text{DIM E} = \text{DIM D} + \frac{.079"}{2.00\text{mm}}$$

RECOMMENDED P.C.B. LAYOUT

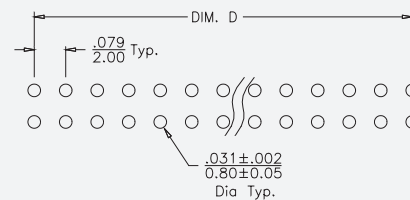

Specification

Materials:

Insulator:

High Temperature Glass Fiber Reinforced Thermoplastic, UL94V-0.

Contact: Brass, 0.5mm Square PIN.

Plating: Gold.

Electrical:

Insulation Resistance:

5000 M Ω Minimum.

Dielectric Withstanding Voltage:

500 VAC R.M.S.

Voltage Rating: 250V.

Current Rating: 1 AMP.

Enviromental

Temperature: -55 $^{\circ}$ C to +125 $^{\circ}$ C

❖ All Dimensions are shown in in/mm.

❖ The above ordering data is for our standard products.

For Non-Standard products, please contact
 TEKCON Electronics Corporation.

PRODUCT NO.	DIM. A		DIM. B		DIM. C	
	mm	in	mm	in	mm	in
1155-A007-XXS	10.00	0.394	5.80	0.228	2.20	0.087
1155-A010-XXS	8.70	0.343	3.90	0.154	2.80	0.110