

RoHS

REV.	ECN. NO.	NAME	DATE
D	THZ0500515	ZJW	07/21/'05
E	THZ0600732	ZLG	08/08/'06
F	THZ1100085	Wavey	08/02/'11

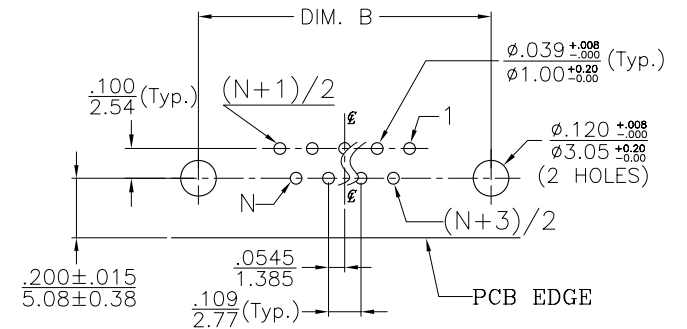

RECOMMENDED P.C.B. LAYOUT
(VIEW FROM TOP SIDE)
GENERAL TOLERANCE .002inch/0.05mm

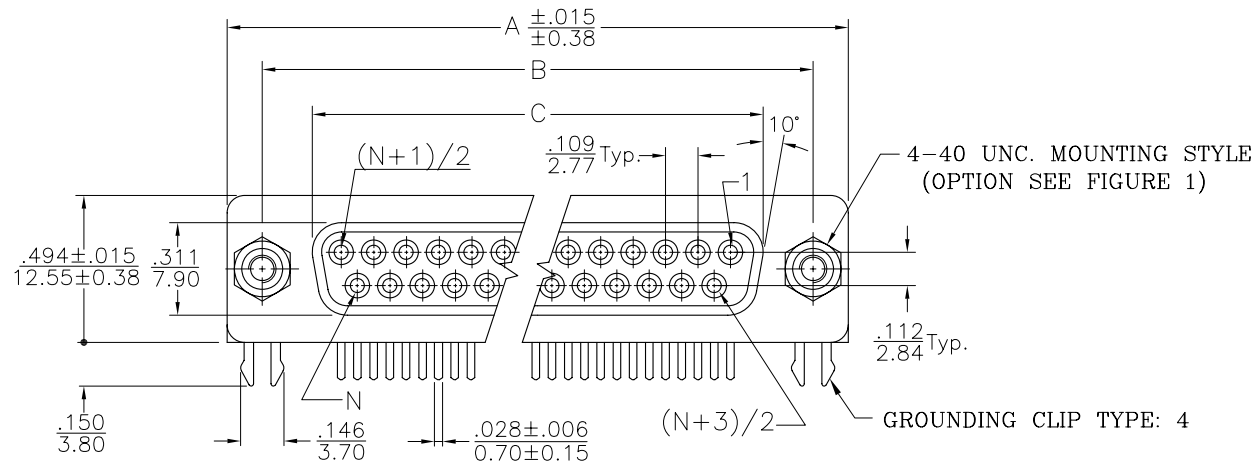
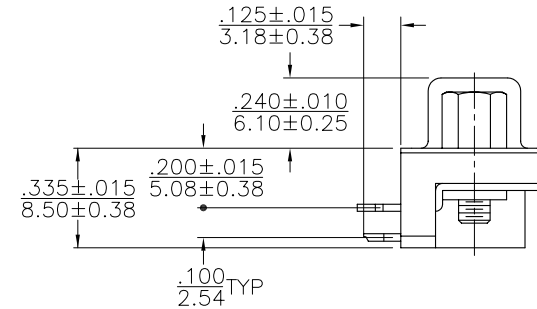
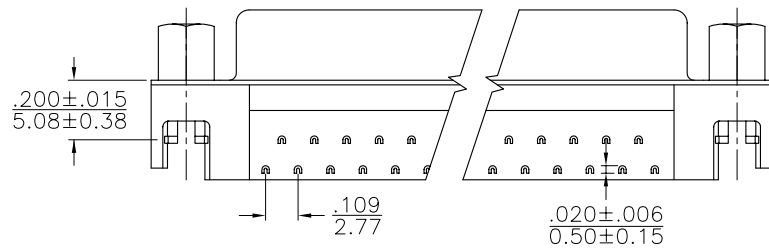

P/N	NO. OF CONTACT	DIM. A		DIM. B		DIM. C	
		mm	inch	mm	inch	mm	inch
1211-XX4-09S-AXX	9	30.84	1.214	24.99	0.984	16.26	0.640
1211-XX4-15S-AXX	15	39.24	1.545	33.32	1.312	24.56	0.967
1211-XX4-25S-AXX	25	53.04	2.088	47.04	1.852	38.30	1.508

TEKCON® ELECTRONICS		TITLE	RIGHT ANGLE D-SUB CONNECTOR .200" FOOTPRINT, RECEPTACLE	
		DWG.NO.	1211-XX4-XXS-AXX	
APP.		TOLERANCE UNLESS OTHERWISE SPECIFIED		
CHK.		UNIT: $\frac{\text{inch}}{\text{mm}}$	LINEAR	.00 ±.015 / 0.0 ±0.38
DR.		ANGLES	± 3'	
DWG.PATH:RD\D-SUB\1211\1211XX4XXSAXX-F(C)		SCALE	1.5:1	SHEET 1 OF 2
		REV:	F	

RoHS

REV.	ECN. NO.	NAME	DATE
D	THZ0500515	ZJW	07/21/'05
E	THZ0600732	ZLG	08/08/'06
F	THZ1100085	Wavey	08/02/'11

NOTES:

1. THE PRODUCT NUMBERS ARE ASSIGNED AS FOLLOWS:

1211 - X X 4-XX S-A X X

- OMIT: STANDARD TYPE
- E: LEAD-FREE TYPE
- T: LEAD-FREE TYPE, MATTE TIN ON CONTACT SOLDER TAIL.

SHELL/GROUNDING CLIP PLATING

CODE	SHELL PLATING	DIP PLATING
A	NICKEL	BRIGHT TIN
B	TIN	BRIGHT TIN
1	NICKEL	MATTE TIN

SPACER TYPE
A - OPEN TYPE

S: RECEPTACLE

NO. OF CONTACT : 09, 15, 25

GROUNDING CLIP
4 - TYPE 4

RIVET & NEX-NUT : TYPE 0, 1, 2, Z
<SEE FIGURE 1>

CONTACT PLATING
CONTACT AREA /SOLDER TAIL

- 0 - GOLD FLASH /TIN
- 1 - 10 μ" GOLD /TIN
- 3 - 30 μ" GOLD /TIN
- 5 - 15 μ" GOLD /TIN

3. ELECTRICAL

- . INSULATION RESISTANCE: 5000 MEGOHMS MINIMUM.
- . DIELECTRIC WITHSTANDING VOLTAGE: 1000 VAC R.M.S.
- . VOLTAGE RATING: 250V.
- . CURRENT RATING: 3 AMP.
- . CONTACT RESISTANCE: 20 MILLIOHMS MAXIMUM.

4. ENVIRONMENTAL

- . TEMPERATURE RANGE: -55°C TO +105°C

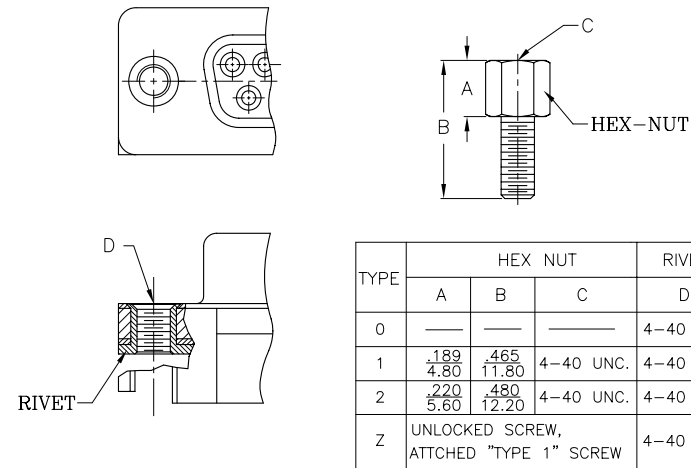

FIGURE 1: OPTION OF HEX-NUT

2. MATERIALS

- . INSULATOR: GLASS FIBER REINFORCED THERMOPLASTIC UL94V-0.
- . SHELL: STEEL WITH NICKEL PLATED (TIN ON REQUEST).
- . CONTACT: COPPER ALLOY WITH GOLD PLATED ON CONTACT AREA AND TIN ON SOLDER TAIL.
- . GROUNDING CLIP: COPPER ALLOY WITH TIN PLATED.
- . RIVET: COPPER ALLOY WITH NICKEL PLATED.
- . HEX NUT: COPPER ALLOY WITH NICKEL PLATED.

TEKCON® ELECTRONICS		TITLE	RIGHT ANGLE D-SUB CONNECTOR .200" FOOTPRINT, RECEPTACLE				
(A4)		DWG.NO.	1211-XX4-XXS-AXX				
APP.			TOLERANCE UNLESS OTHERWISE SPECIFIED				
CHK.			<table border="1"> <tr> <td>LINEAR</td> <td>.00 ±0.015 / 0.0 ±0.38</td> </tr> <tr> <td>ANGLES</td> <td>.000±0.010 / 0.00±0.25</td> </tr> </table>	LINEAR	.00 ±0.015 / 0.0 ±0.38	ANGLES	.000±0.010 / 0.00±0.25
LINEAR	.00 ±0.015 / 0.0 ±0.38						
ANGLES	.000±0.010 / 0.00±0.25						
DR.		UNIT:	<table border="1"> <tr> <td>inch</td> <td></td> </tr> <tr> <td>mm</td> <td></td> </tr> </table>	inch		mm	
inch							
mm							
DWG.PATH:RD\0-SUB\1211\1211XX4XXSAXX-F(C)		SCALE	1.5:1 SHEET 2 OF 2 REV: F				